

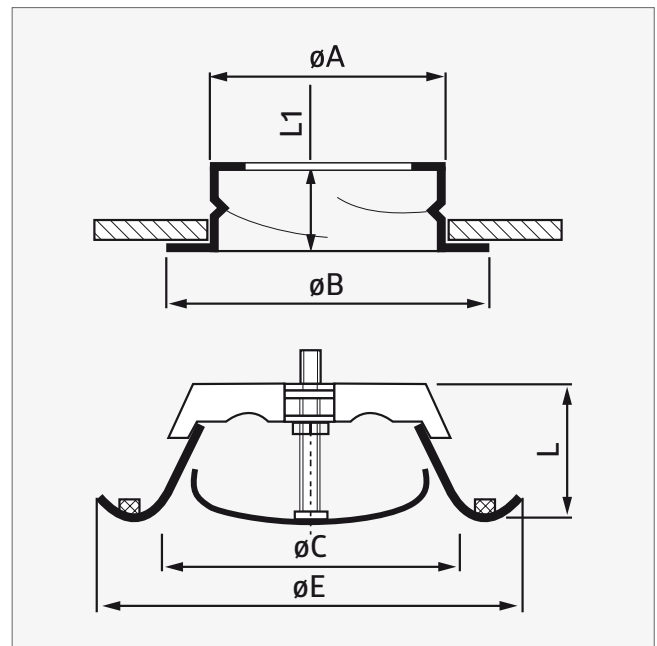

## Exhaust air valve **SR-E**



### PRODUCT CHARACTERISTICS:

- exhaust air valve designed for ceiling mounting on ventilation ducts
- easy adjustment of air flow by rotating central part
- blocking nut allows for setting the minimum slot
- special design provides low noise level
- high quality and modern design
- fast and easy installation

### MATERIAL AND COLOUR:

- galvanized steel
- RAL 9003

|                 | $\varnothing A$<br>[mm] | $\varnothing B$<br>[mm] | $\varnothing C$<br>[mm] | $\varnothing E$<br>[mm] | L<br>[mm] | L1<br>[mm] |  |
|-----------------|-------------------------|-------------------------|-------------------------|-------------------------|-----------|------------|---|
| <b>SR-E 80</b>  | 79,0                    | 105,0                   | 59,0                    | 115,9                   | 37,5      | 48,5       | 7   |
| <b>SR-E 100</b> | 98,4                    | 125,3                   | 74,0                    | 139,5                   | 39,0      | 48,5       | 7   |
| <b>SR-E 125</b> | 124,2                   | 150,0                   | 98,0                    | 165,0                   | 43,5      | 48,5       | 7   |
| <b>SR-E 150</b> | 148,5                   | 175,0                   | 119,7                   | 201,0                   | 51,0      | 48,5       | 7   |
| <b>SR-E 160</b> | 158,5                   | 185,0                   | 129,0                   | 208,0                   | 49,0      | 48,5       | 7   |
| <b>SR-E 200</b> | 198,5                   | 225,0                   | 157,0                   | 247,4                   | 57,0      | 48,5       | 7   |
| <b>SR-E 250</b> | 247,0                   | 286,5                   | 207,7                   | 304,0                   | 64,0      | 45,0       | 7   |

 Packaging [pcs]

